

ACCOMMODATIONS SYMBOL LEGEND

- ▲ Twin Bed and Single Sofa Bed
- ★ 2 Twin Beds (convert to King) and Single Sofa Bed
- 2 Twin Beds (convert to King) and 1 Upper Pullman
- ◊ 2 Twin Beds (convert to King) and 2 Upper Pullmans
- 2 Twin Beds (convert to King), Single Sofa Bed and 1 Upper Pullman
- † 2 Twin Beds (convert to King) and Double Sofa Bed

- ▷ 2 Twin Beds (convert to King), Double Sofa Bed and 1 Lower Pullman
- ◆ Stateroom with 2 Porthole Windows
- ◁ Connecting staterooms (ideal for families and groups of friends)

- U Unisex Wheelchair Accessible Restroom
  - ★ Twin beds do not convert to a King Bed.
  - 68 Staterooms with obstructed views: 2446, 2449.
  - ⊘ All accommodations are non-smoking.
- Staterooms are available that are modified for wheelchair users. Please contact Carnival Reservations Department, Guest Access Services, at 1-800-438-6744, ext. 70025, for details.

CATEGORIES

- 1A Interior Upper/Lower
- P1 Porthole
- 4A 4B 4C 4D 4E 4F 4G 4H Interior
- 4J Interior with Picture Window (obstructed views)
- 6A 6B 6C Ocean View
- 6J Scenic Ocean View
- 6K Scenic Grand Ocean View
- 8A 8B 8C 8D 8E 8F Balcony
- 8M 8N Aft-View Extended Balcony
- 9B Premium Balcony
- 9C Premium Vista Balcony
- 9S Junior Suite
- 9S Ocean Suite
- 9S Grand Suite
- 9S Captain's Suite

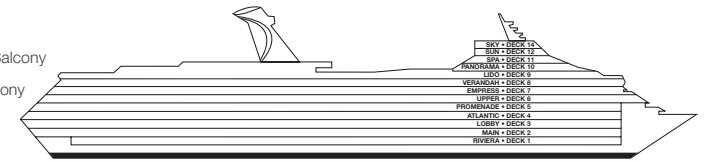

Gross Tonnage: 110,000 Length: 952 Feet Beam: 116 Feet  
 Cruising Speed: 21 Knots Guest Capacity: 2,980 (Double Occupancy)  
 Total Staff: 1,150 Registry: Panama



Riviera • Deck 1

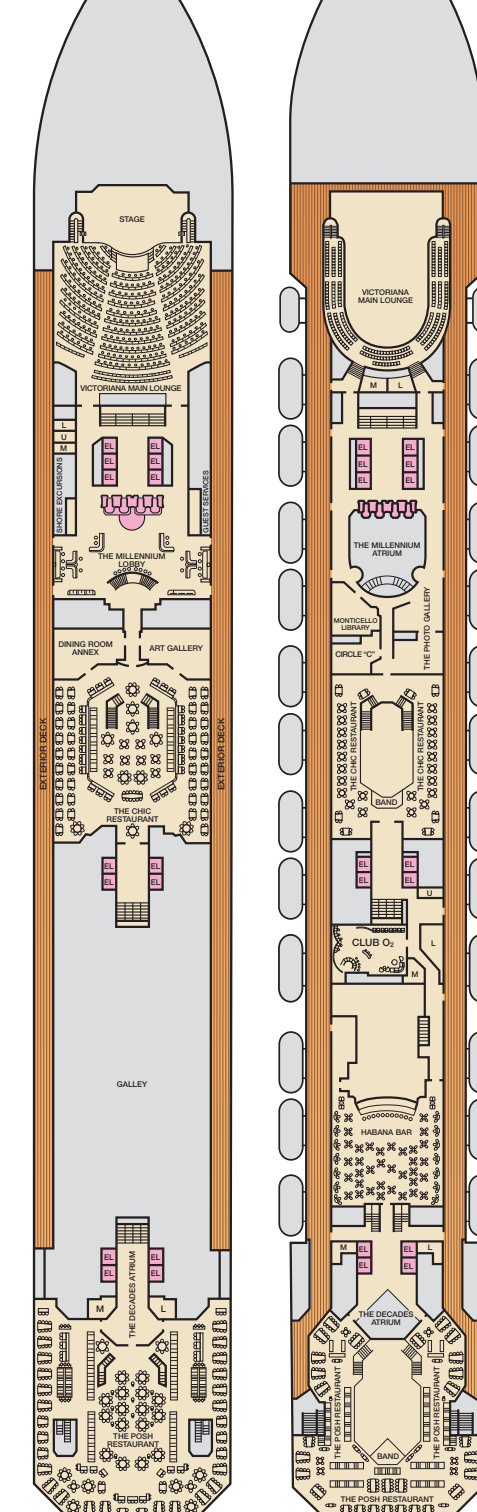

Main • Deck 2



Lobby • Deck 3



Atlantic • Deck 4

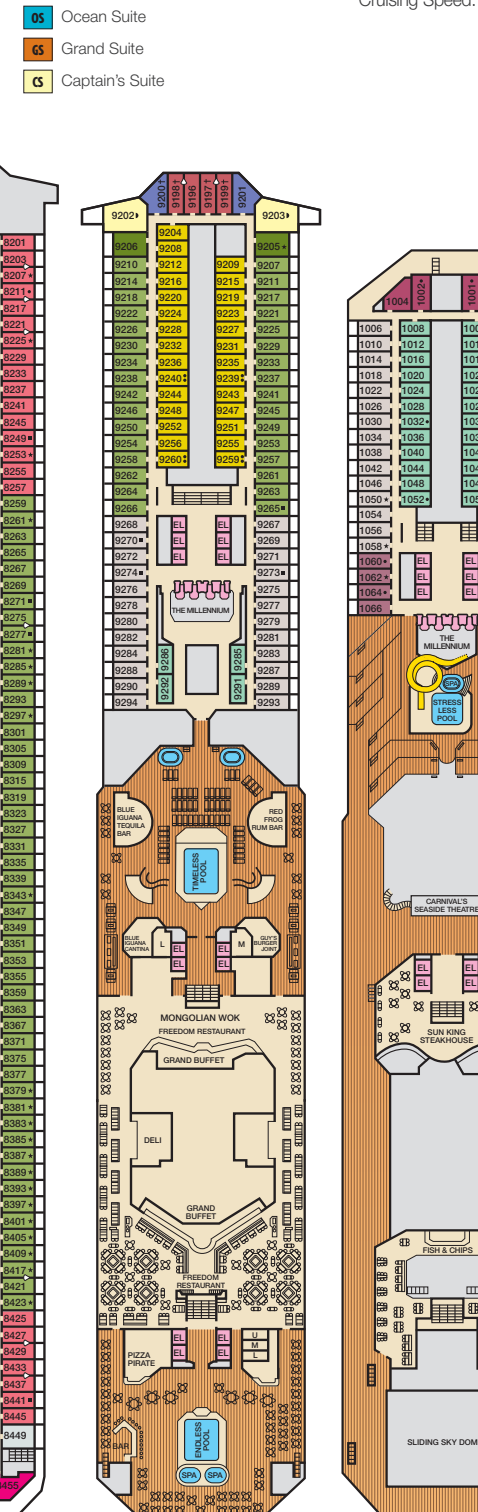

Promenade • Deck 5

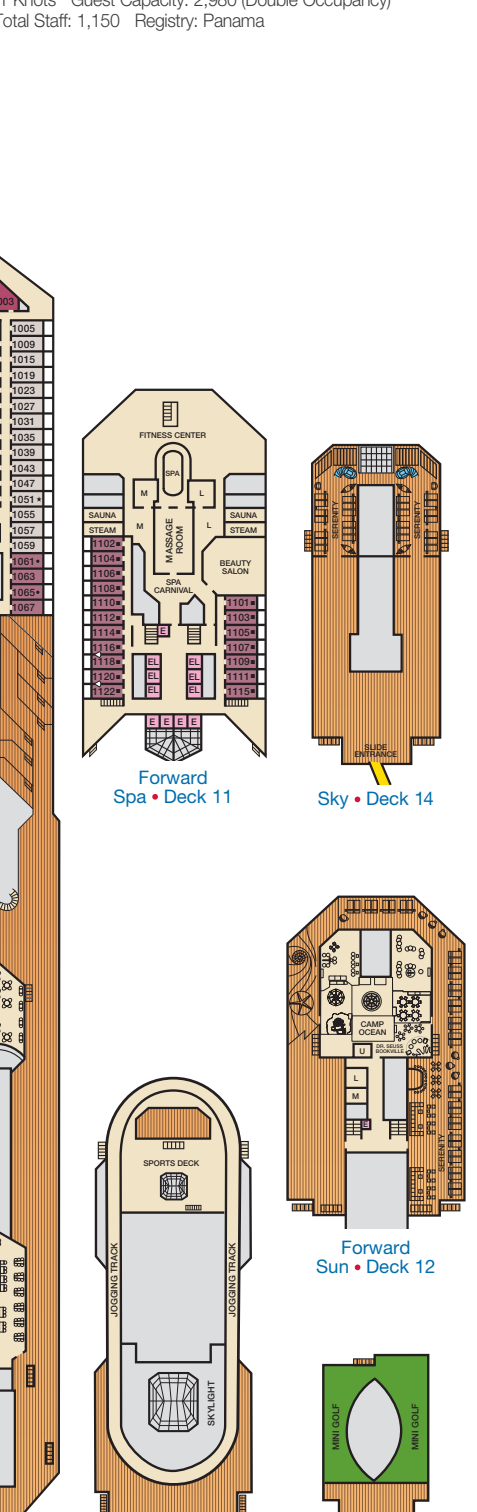

Upper • Deck 6



Empress • Deck 7



Verandah • Deck 8



Lido • Deck 9

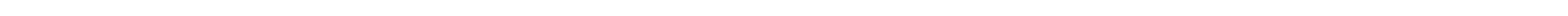

Panorama • Deck 10

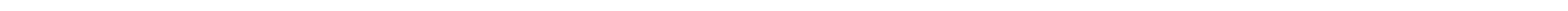

Aft Spa • Deck 11



Aft Sun • Deck 12